

Field

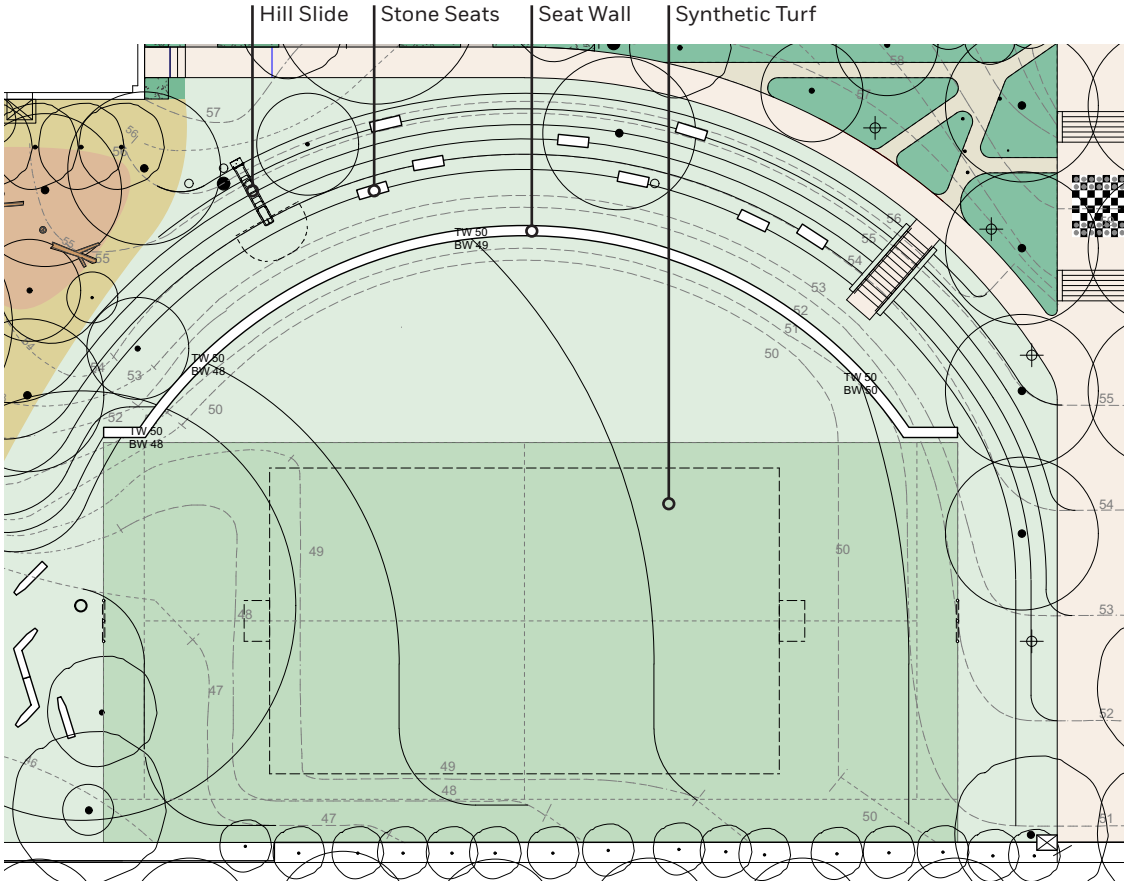

SYNTHETIC TURF

SOIL TURF

PRO's

<ul style="list-style-type: none"> Low maintenance No field time lost Great drainage Low annual cost No fertilizer needed No bees 	<ul style="list-style-type: none"> Soft grass
---	--

CON's

<ul style="list-style-type: none"> Expensive up-front cost Not as soft as grass No dogs allowed - will need to put up signs or control access; may need to flush the field sometimes Seams may show over time with great use Repair may be needed from time to time 	<ul style="list-style-type: none"> Regular maintenance and cost required Fertilizer required (can be organic) Must aerate and reseed annually Irrigation required Field use may be limited for maintenance Field use is dependent on weather Annual maintenance cost: \$17,000
--	---





The field is regraded and converted to synthetic turf. This space is very clearly the core of student recess activity. Striping the field and offering smaller side fields will allow multiple game types to happen at once. A new seat wall both helps maintain the grade and offers seating. A hill slide aids in some of the more imaginative renditions of tag we heard about from many students.

Fitness Equipment

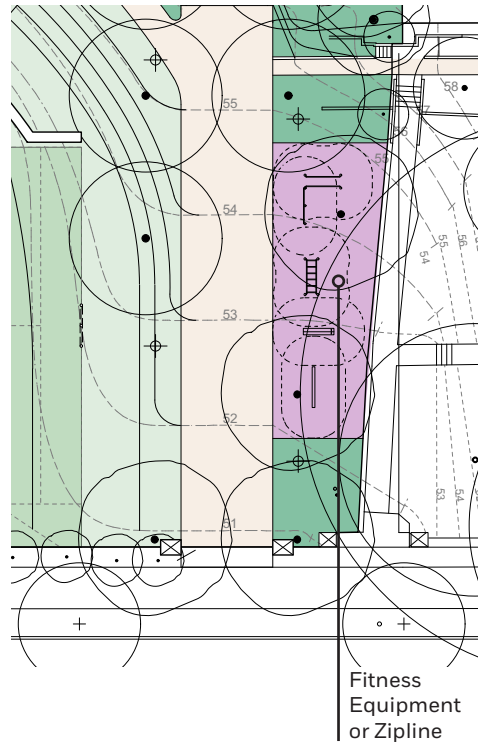

Proposed fitness equipment.



Alternatively, a zipline would fit in this space.